

★ **YODER SMOKERS** ★
PREMIUM GRILLS & SMOKERS

FLAT TOP CHARCOAL GRILL ROTISSERIE INSTALLATION MANUAL

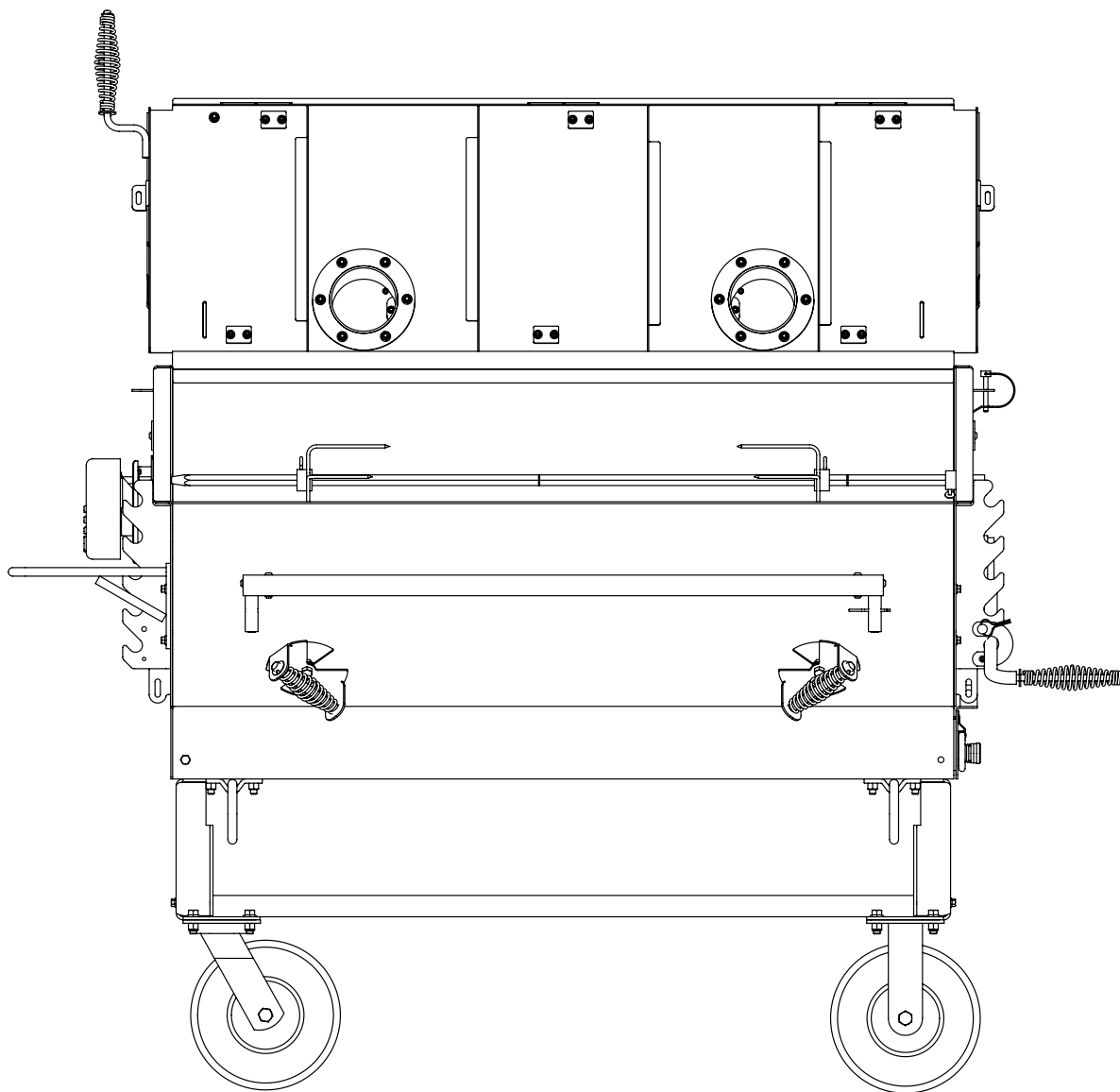

★ YODER SMOKERS ★

PREMIUM GRILLS & SMOKERS

BEFORE YOU GET STARTED



Begin by confirming all the parts included in this kit are accounted for in this kit. *Should any items be missing, please contact Customer Service for assistance at 877.409.6337 or customerservice@yodersmokers.com.*

PARTS INCLUDED

(1) Three-piece Spit Rod (2) Spit Rod Forks (2) Copper Washers (1) Bushing
(1) Motor (1) Motor Mount (1) Motor Mount Bracket (1) Motor Heat Shield
(4) M4 Screws (4) 1/4" Bolts 4) 1/4" Nuts

TOOLS YOU'LL NEED

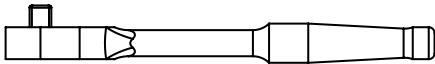
3/16" hex key | 7/16" wrench & socket | phillips screwdriver

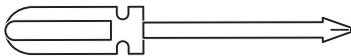
SOCKET WRENCH	
7/16" SOCKET	
3/16" HEX KEY	
PHILLIPS SCREWDRIVER	

DRILLING HOLES FOR INSTALLATION

STEP 01

*If installing on a single-stack grill, drill holes to accommodate the rotisserie using the provided stepped drill bit. Refer to the diagrams for hole locations. If your grill has dual smokestacks, skip to Step 04. **Safety Warning: Always wear eye protection and gloves when drilling.***

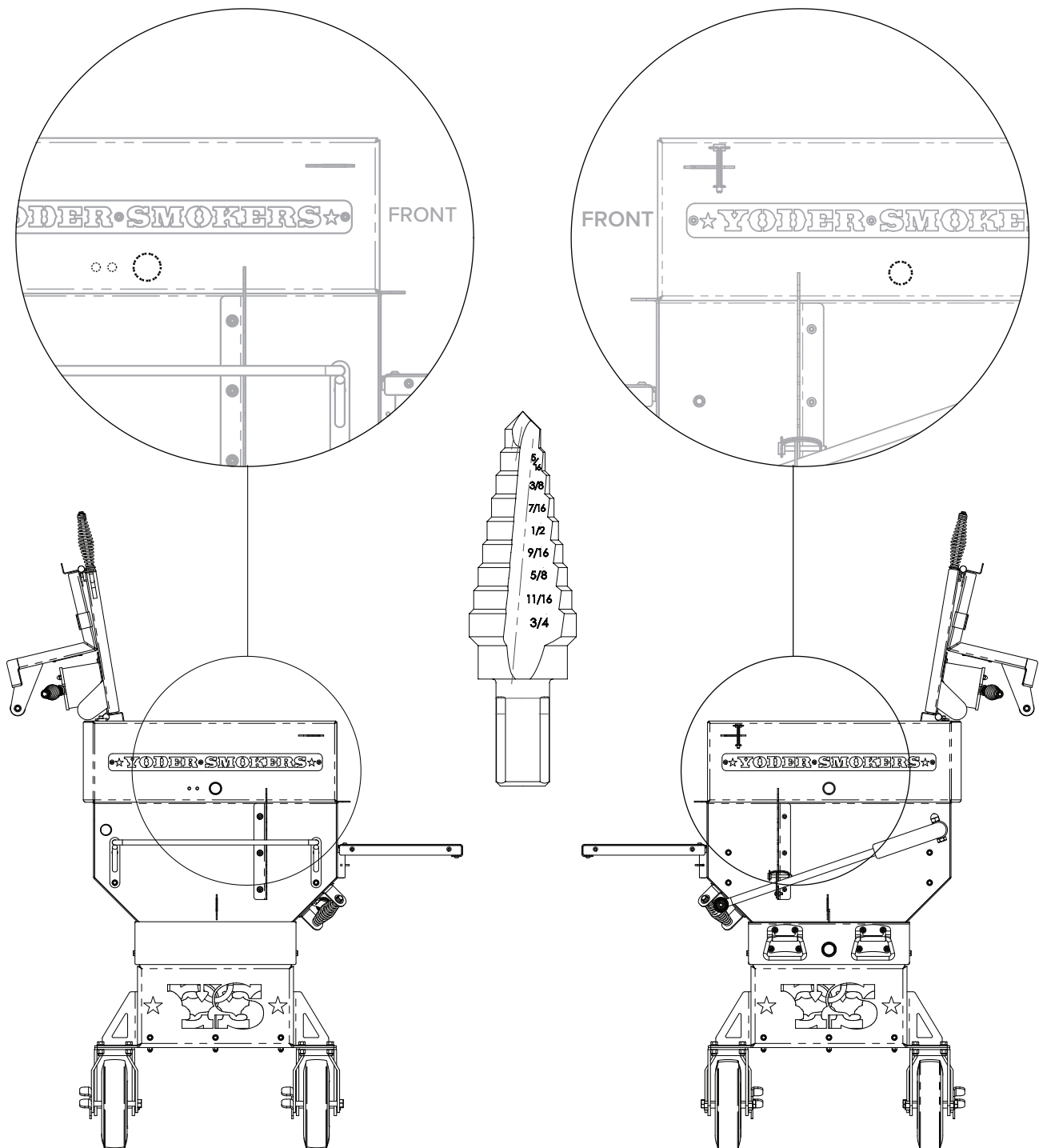

DRILLING HOLES ON MOTOR SIDE

STEP 02

On single-stack grills, drill three holes on the left-hand side (the side with the pull handle). Measurements are taken with the grill lid open, referenced from the front and top edges of the grill. Drill one $\frac{3}{4}$ -inch hole and two $\frac{1}{4}$ -inch holes.

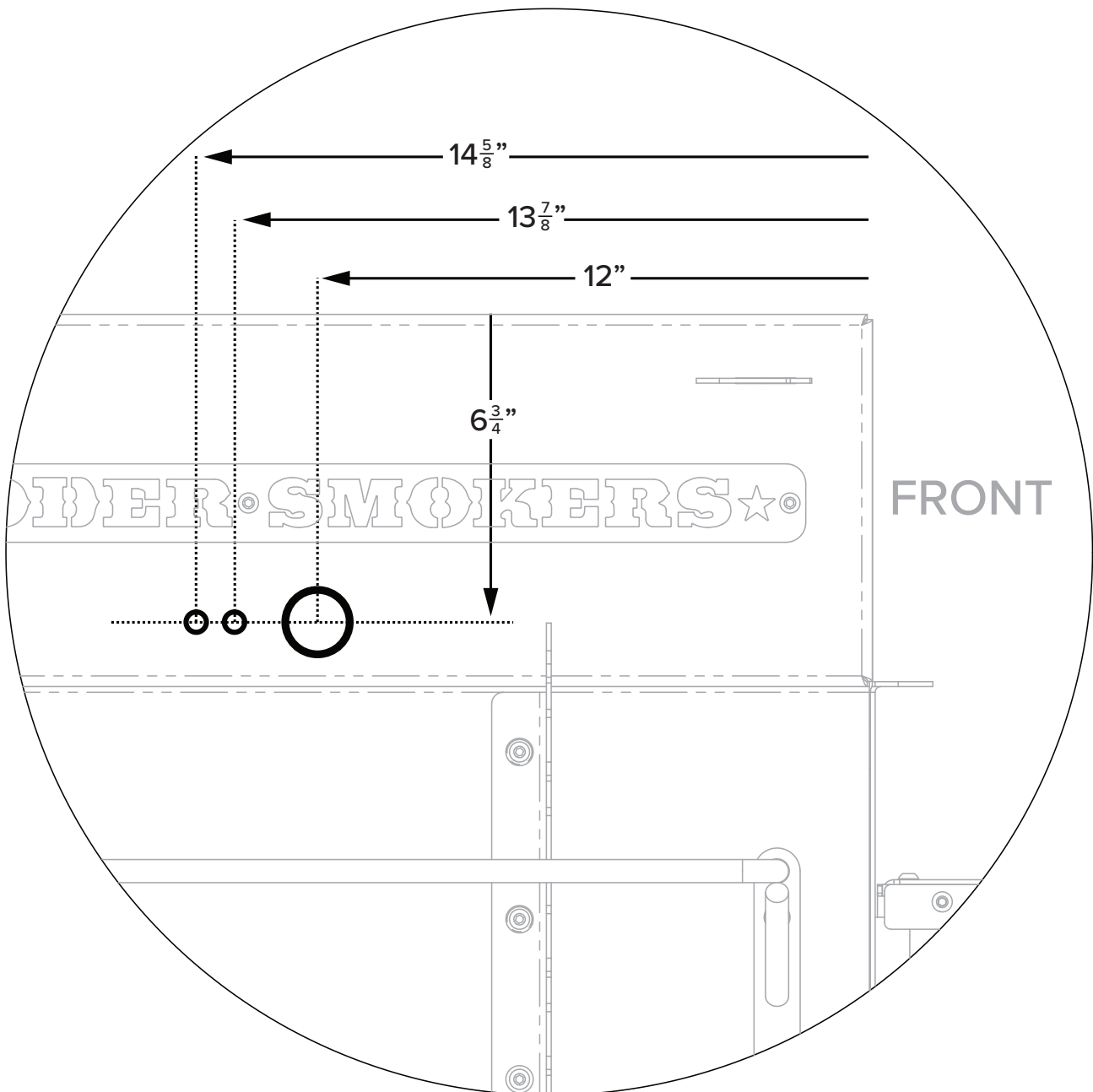

DRILLING HOLES ON OPPOSITE SIDE

STEP 03

On the opposite side of the grill, drill one $\frac{3}{4}$ -inch hole according to the provided diagram.
Skip this step for dual-stack grills.

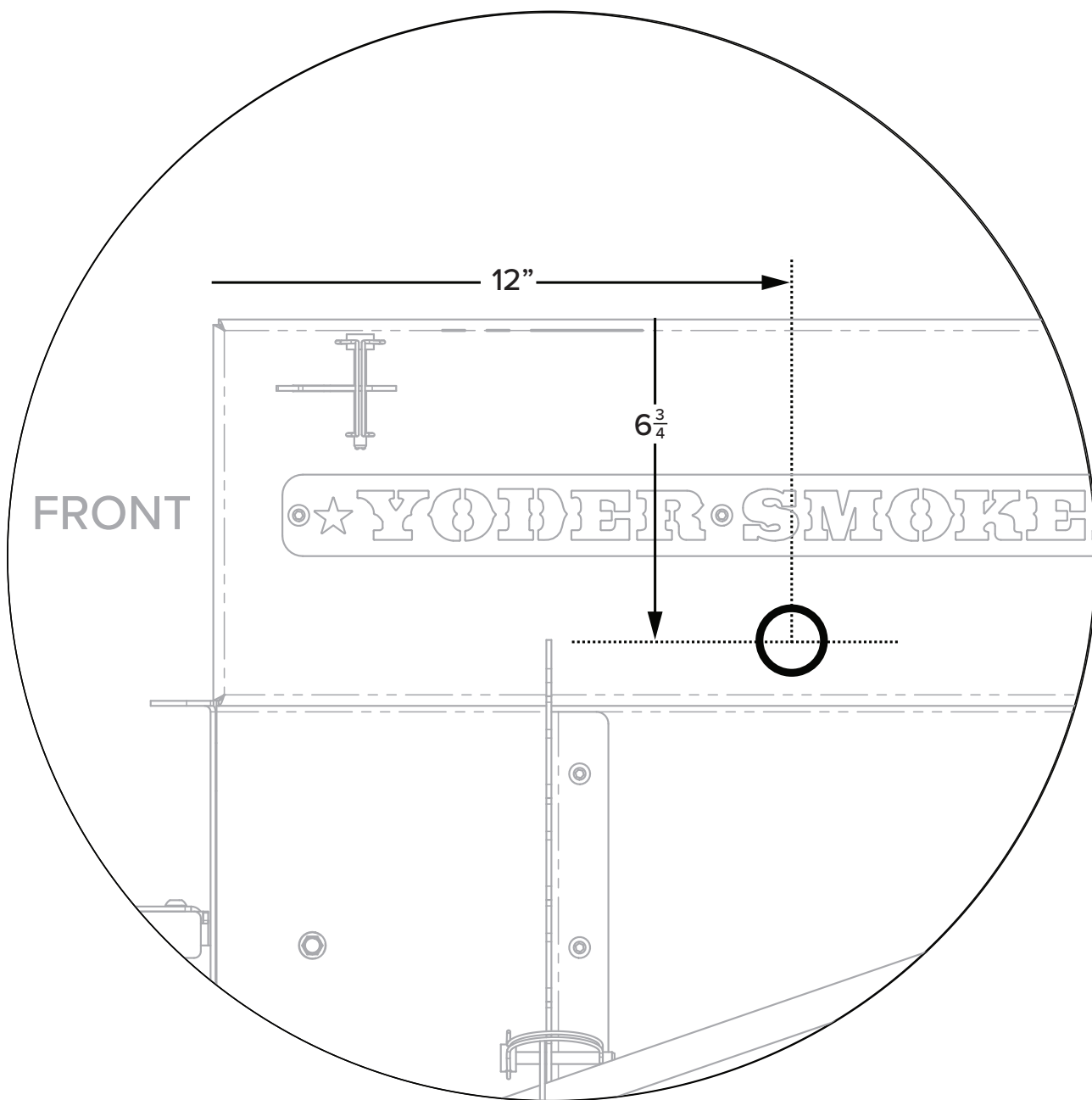

PREPARING THE GRILL

STEP 04

Remove both cooking grates and silicone plugs from both sides of the grill. Then, remove the screws and nuts from the side opposite the lift handle.

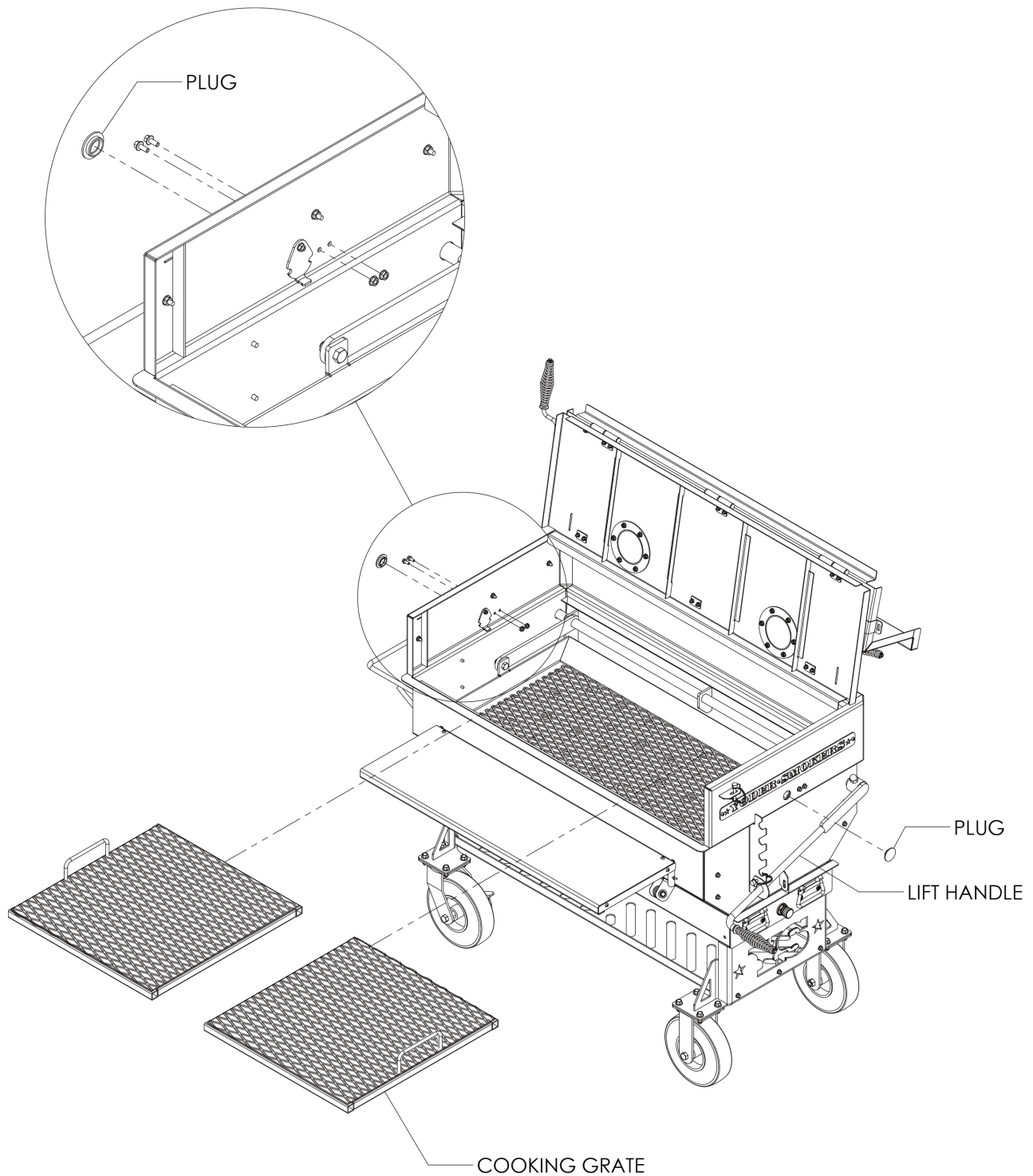

ATTACHING THE MOTOR MOUNT

STEP 05

Install the motor mount brackets and heat shield using the provided hardware. Pay close attention to the orientation of the brackets to ensure correct motor installation.

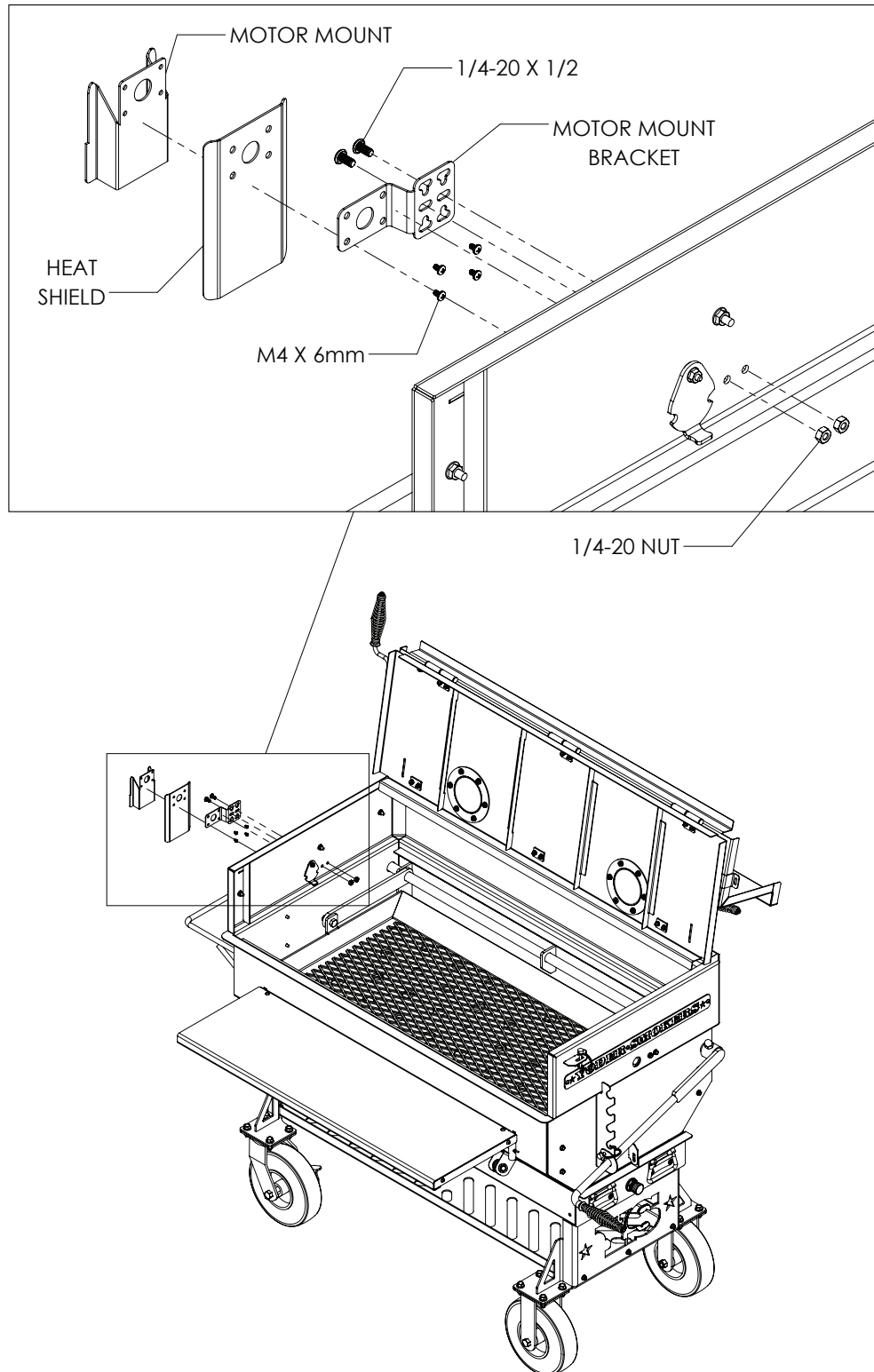

INSTALLING THE MOTOR

STEP 06

Slide the motor directly onto the motor mount bracket as shown in the diagrams. Ensure it locks securely in place. **Caution:** Keep the motor cord away from hot surfaces and moisture.

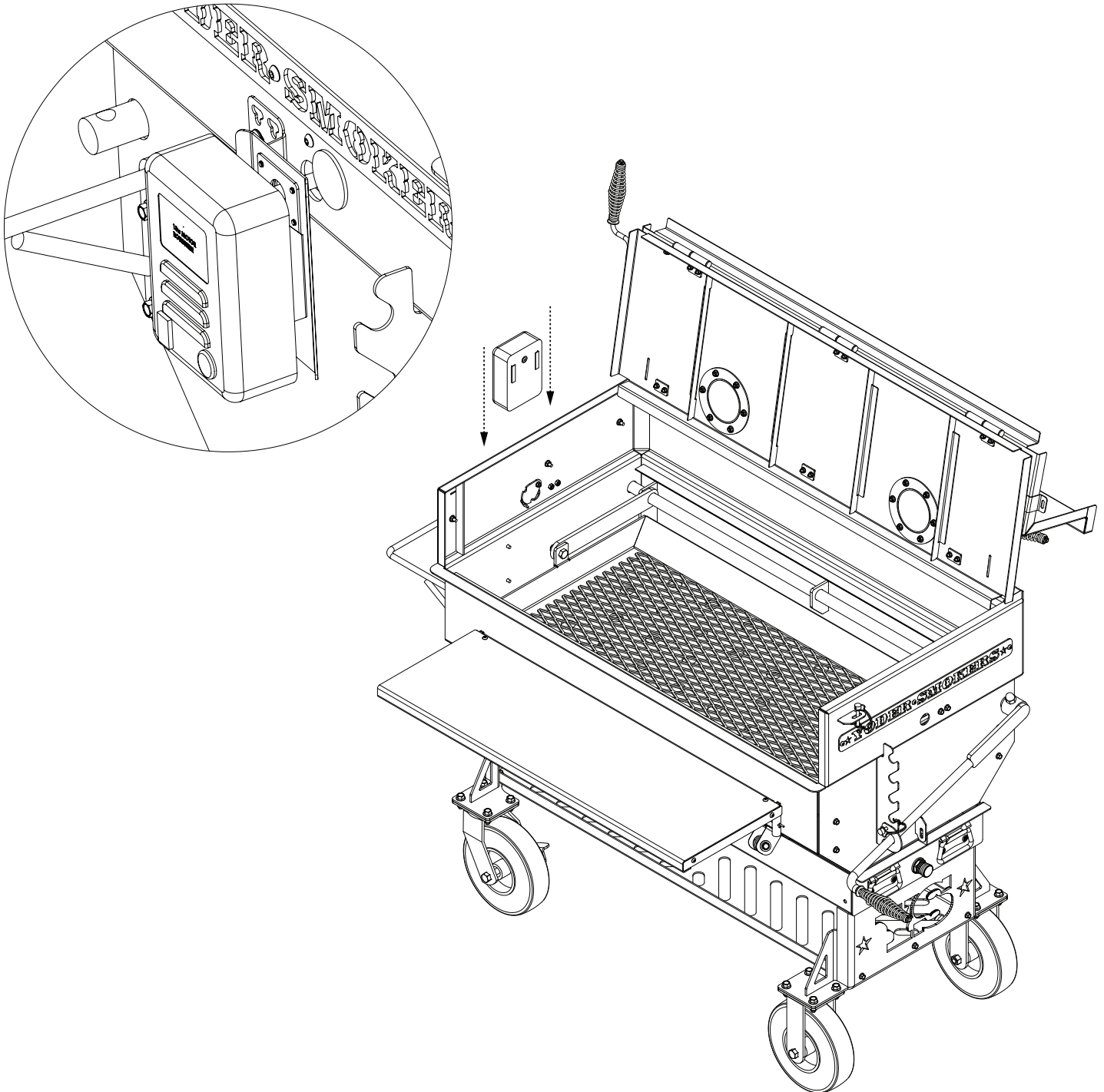

ASSEMBLING THE SPIT ROD

STEP 07

Assemble the spit by connecting the sections together. Install a copper washer between each section to prevent binding. Load food onto the spit and secure with the provided forks. Tighten the set screws to lock forks in place. Install the bushing on the ends of the spit for later securing inside the grill.

Note: *Tighten the spit sections just enough to compress the washer slightly.*

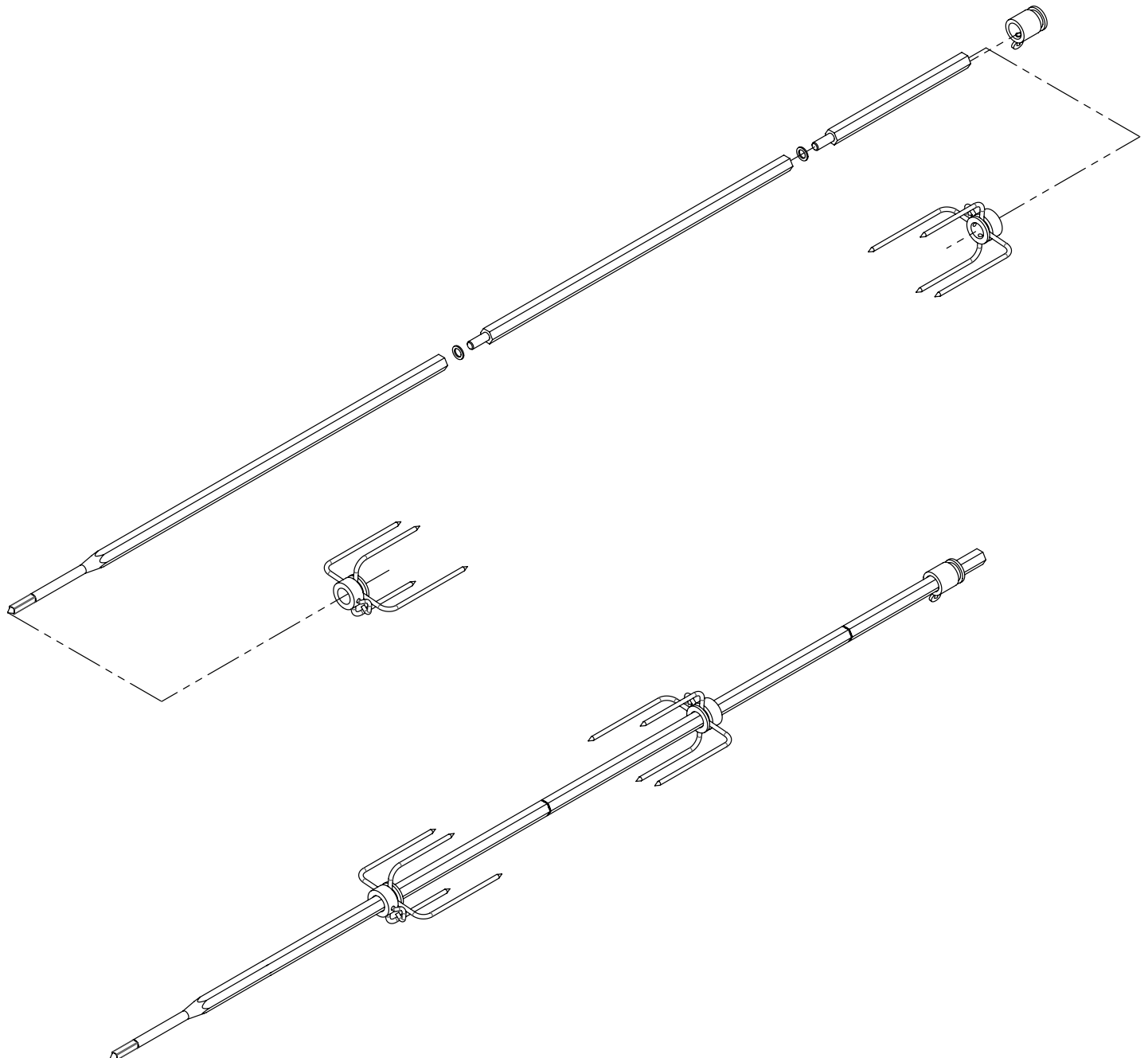

INSTALLING THE SPIT ROD

STEP 08

Insert the loaded spit rod through the hole opposite the motor. Pivot the probe port cover to the open position and guide the square drive end of the spit rod into the motor.

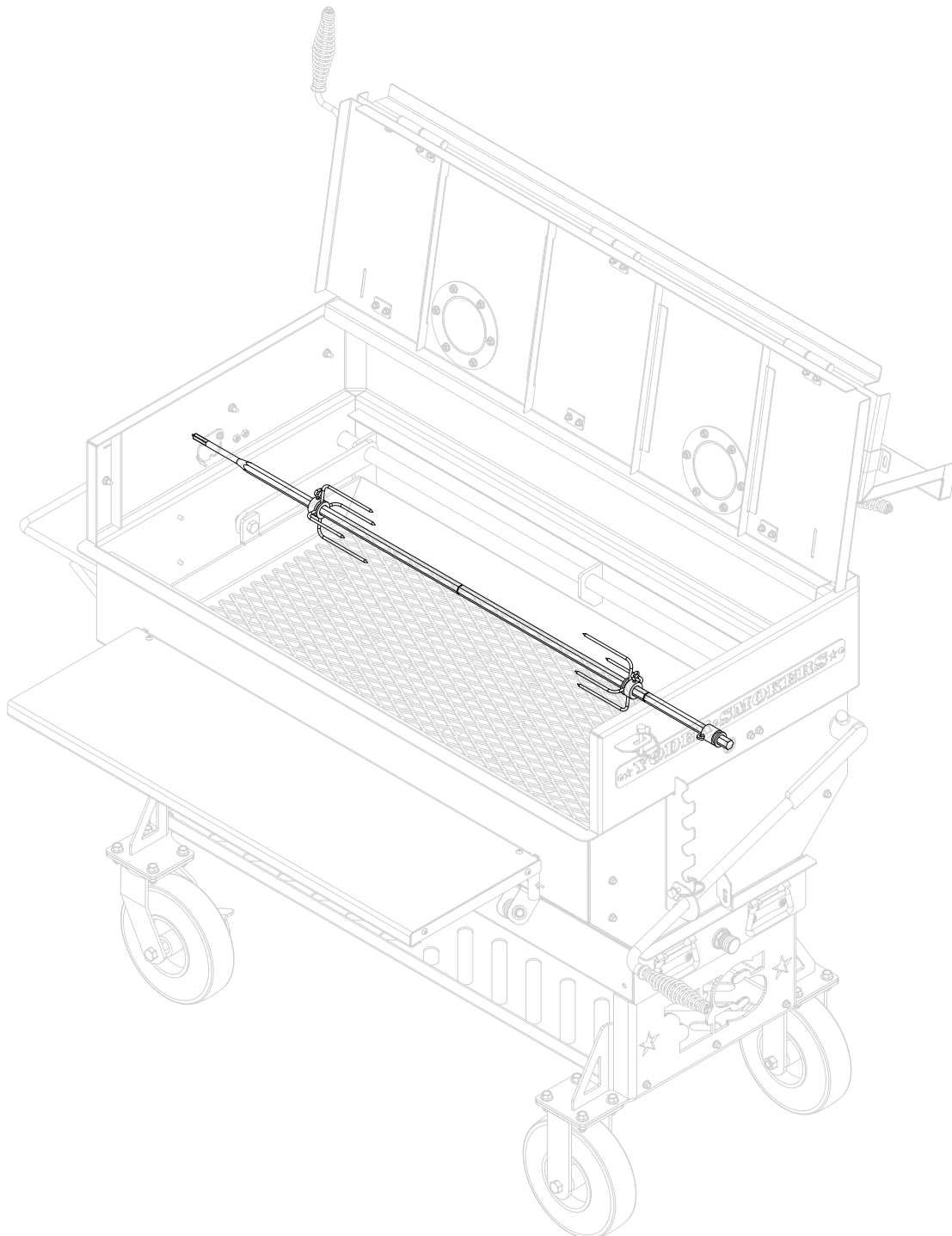

SECURING THE SPIT ROD

STEP 09

Lock the bushing to the spit rod inside the wall opposite the motor. This prevents the rod from working free during cooking. Once secured, plug in the power cord and your grill is ready to cook.

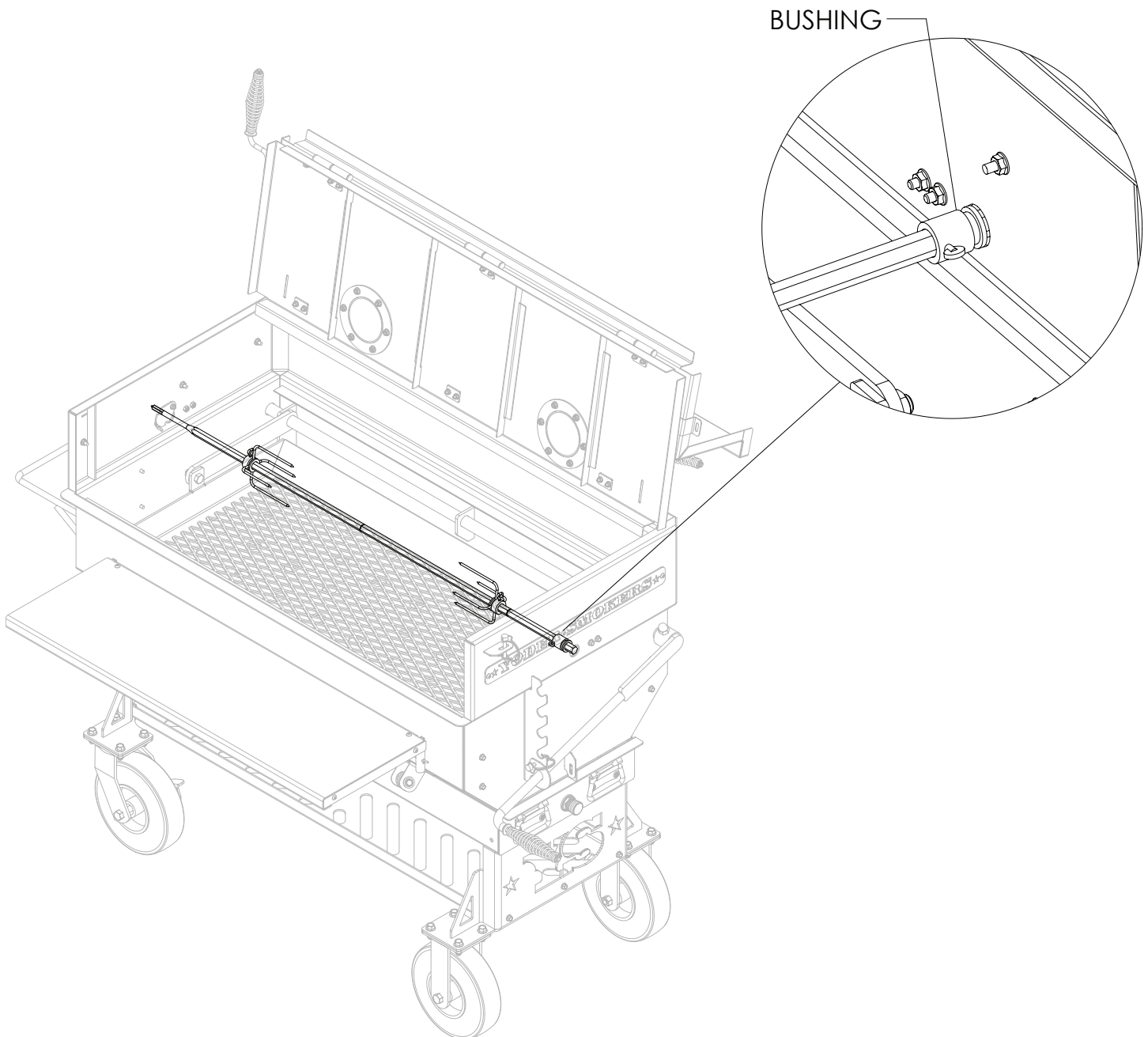

INSTALLATION COMPLETE

YOUR ROTISSERIE IS NOW READY FOR USE.



FOR PRODUCT SUPPORT:
CustomerService@YoderSmokers.com
877.409.6337 (OPTION 2)

★ **YODER SMOKERS** ★
PREMIUM GRILLS & SMOKERS